



## LG LED All-in-One (LABA Series)

# LED Display Supporting FHD Resolution

### Key Features and Specifications (FHD resolution configuration case)



Large Screen  
P1.5 / 1,920 × 1,080



Built-in Speaker &  
A Control Box



Dedicated  
Accessories



Easy Installation  
Quick Maintenance

Pixel Pitch	1.58 mm
Brightness	500 nit (Max., After Calibration)
Screen Resolution	1,920 × 1,080
Serviceability	Front
Speaker	Built-in
Controller	CABA-015D (Control Box, webOS)



## FHD LED Screen with Built-in Speaker

LABA series with Full HD screen size includes a control box and built-in speaker. Eliminating the prejudice that LED displays are difficult and complex to install, it doesn't require controller connections or module configuration. After a simple installation process, all you need to do is to turn on the screen with a remote control like home TV.

\* Only for FHD resolution configuration case



## High Performance with webOS

Built-in Quad Core SoC (System on Chip) can execute several tasks at once for providing smooth content playback. Also, LG webOS Smart Platform enhances user convenience with intuitive GUI and provides to SI or/and developers simple app development tools\* such as SDK (Software Development Kit), SCAP, sample applications.

\* The webOS Signage Developer site (<https://webossignage.developer.lge.com>) provides SDK tools and documentation for creating apps on LG Digital Signage. This is only open to partners.

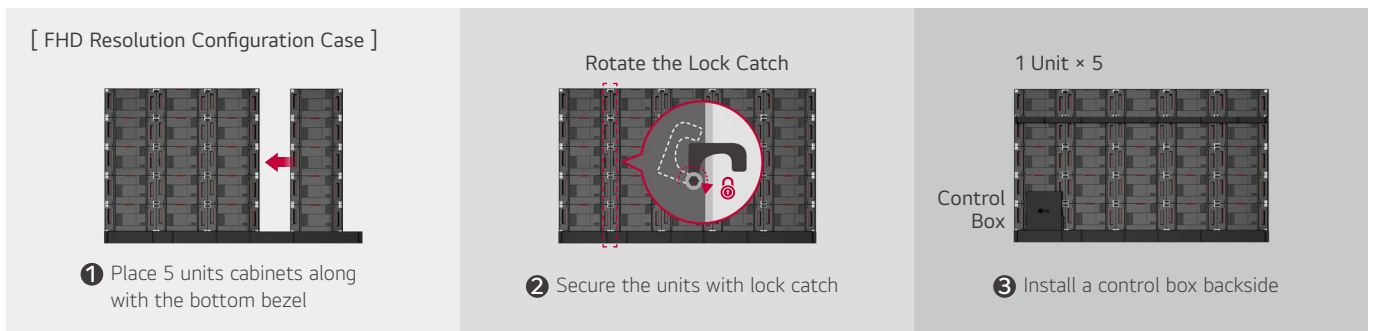

## Easy Installation (for FHD Resolution Configuration Case)

Thanks to the carbon fiber tubes and locks located behind the cabinets, installation is straightforward. Simply place the 5 units of cabinets, connect and secure them with locking catches. Then the assembly is done. 5 cabinets forming a unit are pre-assembled with carbon fiber tubes and each unit can be held tightly with lock catches.

\* Fixing screws or installing wall mount/accessories is needed additionally.



## Office Meeting Mode

With Office Meeting Mode, easily configure meeting room details like the room number and current time. It also includes convenient features like automatic input switching, a presentation timer, and adjustable settings such as auto-brightness and picture mode.

\* Users can enable Office Meeting Mode at EZ Setting menu of the Signage.

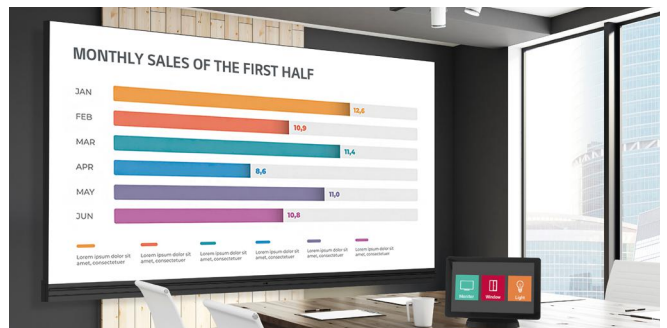

## Compatible with AV Control Systems

The LABA series supports Crestron Connected®\* for high compatibility with professional AV controls to achieve seamless integration and automated control\*\*, boosting business management efficiency.

\* Initial setting from display is required for Crestron Connected® compatibility.

\*\* Network based control

\*\*\* Crestron Connected® needs to be purchased separately.



Landscape Wall Mount



Dedicated Stand

\* Optional (Available for purchase separately)



## Dedicated Installation Accessories (for FHD Resolution Configuration Case)

The product includes necessary components including the landscape wall mount and tools for installation. The dedicated stand is provided as an option, so that you can easily place it depending on your installation sites.

\* Stand accessory needs to be purchased separately.



## Display Power Management (DPM)

The DPM function of the LED screen allows it to enter a standby mode after a specific period of time when there is no signal from the input source device.

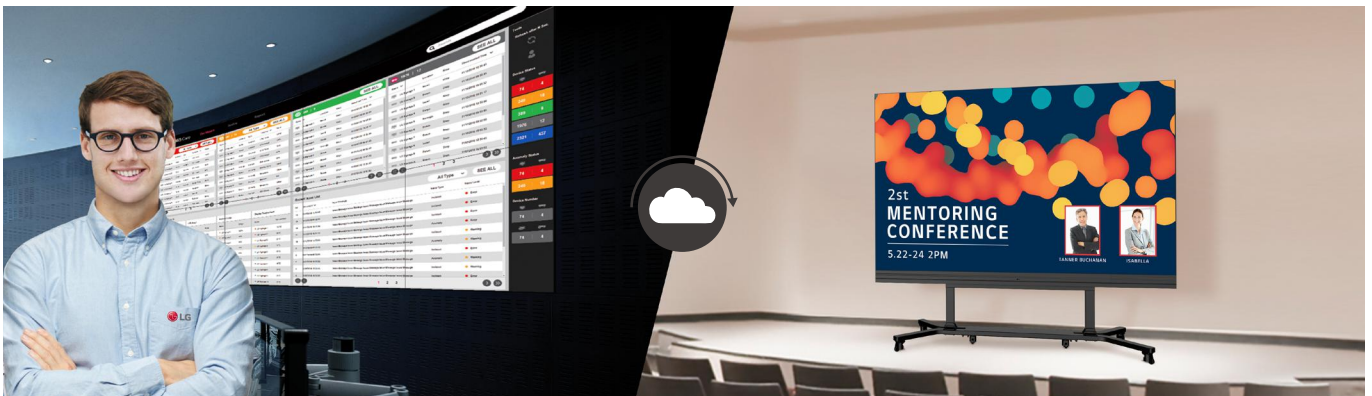

## Real-time LG ConnectedCare

Maintenance is easy and fast with the optional LG ConnectedCare\* service, a cloud service solution provided by LG. It remotely manages the status of displays in client workplaces for fault diagnosis and remote-control services, enabling the stable operation of clients' businesses.

\* The availability of LG ConnectedCare differs by region.

\*\* Stand accessory needs to be purchased separately.

\*\*\* LG ConnectedCare Service needs to be purchased separately, and available on the basis of internet connection.

## SPECIFICATIONS

FHD Resolution Configuration Case  
with LABA015-GD 5 × 5

Physical Parameters	Pixel Configuration	Single SMD
	Pixel Pitch (mm)	1.58
	Module Resolution (W × H)	96 × 216
	Module Dimensions (W × H, mm)	151.2 × 340.2
	No. of Modules per Screen (W × H)	20 × 5 (Total 100)
	Screen Resolution (W × H)	1,920 × 1,080
	Screen Dimensions (W × H × D, mm)	3,035 × 1,821.5 × 45.5 (Thickest 83.5)
	Screen Surface Area (m <sup>2</sup> )	5.14
	Screen Weight (kg)	154
	Physical Pixel Density (pixels/m <sup>2</sup> )	403,124
	Flatness of Cabinet (mm)	≤0.15
	Cabinet Material	Die-casting Aluminum
Service Access	Front	
Optical Specifications	Max. Brightness (After Calibration, nit)	500
	Color Temperature (K)	3,200-9,300
	Visual Viewing Angle (H × V)	160 × 140
	Brightness Uniformity	97%
	Color Uniformity	±0.003 Cx, Cy
	Contrast Ratio	8,000 : 1
	Processing Depth (bit)	16 (HDR10, HDR10 Pro)
Electrical Specifications	Power Consumption (W/Screen, Max.)	1,600
	Power Consumption (W/Screen, Avg.)	950
	Power Consumption (W/m <sup>2</sup> , Max.)	300
	Power Consumption (BTU/h/Screen, Max.)	5,456
	Power Consumption (BTU/h/Screen, Avg.)	3,240
	Power Consumption (BTU/h/m <sup>2</sup> , Max.)	1,023
	Power Supply (V)	100 to 240
	Frame Rate (Hz)	50 / 60
	Refresh Rate (Hz)	3,840
Operation Specifications	Lifetime (Half Brightness)	100,000
	Operating Temperature (°C)	0 to +40
	Operating Humidity	10-80% RH
	IP Rating (Front / Rear)	IP50 / IP50
Speaker	Built-in (8 W + 8 W)	
Certification	CE, FCC, cTUVus, CB, EMC Class A	
Environment	RoHS, REACH	
Controller	CABA-015D (Control Box, webOS)	
I/O Port	HDMI (3), DP (1), USB, LAN, RS232C In/Out, IR, Optical Digital Audio Out	

\* Specifications are subject to change without notice. Please make sure to check the product manual for details about product usage.

## CONNECTIVITY

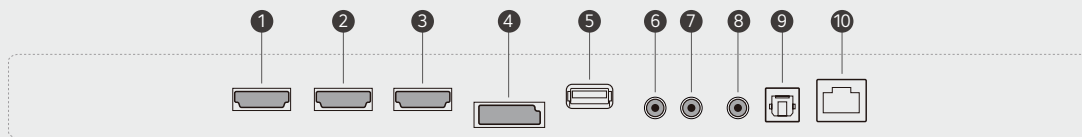

- ① HDMI 1
- ② HDMI 2
- ③ HDMI 3

- ④ DP IN
- ⑤ USB 2.0 IN
- ⑥ RS-232C IN

- ⑦ RS-232C OUT
- ⑧ IR
- ⑨ OPTICAL DIGITAL AUDIO OUT

- ⑩ LAN



Download  
LG C-Display+  
Mobile App

Google Play Store

- www.lg.com/global/business/information-display
- www.youtube.com/c/LGCommercialDisplay
- www.facebook.com/LGInformationDisplay
- www.linkedin.com/company/LGinformationdisplay
- www.twitter.com/LG\_ID\_HQ

LG may make changes to specifications and product descriptions without notice. Copyright © 2024 LG Electronics Inc. All rights reserved. "LG Life's Good" is a registered trademark of LG Corp. The names of products and brands mentioned here may be the trademarks of their respective owners.